

RTD Thermometer *omnigrad TST602*

**Surface thermometer suitable for application
measurement on flat surfaces or pipes
Connection cable, radius or flat mounting block**



Description

TST602 RTD thermometer consists of a radius or flat mounting block in aluminium including a built-in RTD, matched to a connection cable. The sensing element includes a single Pt100, in fiberglass insulated cable, having accuracy class A or B, with 3 or 4 wires. The connection cable, with free end wires and PVC or PTFE insulated, can be selected from a wide choice of standard lengths for any application up to 70°C or 180°C. It is supplied with free end wires.

Application

TST602 RTD thermometer is a general purpose thermometer for surface measurements. It is suitable for application on flat surfaces or pipes and is specially designed for climatisation and general application in building automation and heat exchangers.

Technical data

Probe

Sensing element:

Tolerances:

Insulation:

Wiring:

Insulation resistance:

Mounting

Versions:

Standard material:

Dimensions:

Connection cable

Versions:

Standard lengths:

Operating temperature:

Electrical connection:

Platinum resistance, 1 x Pt100 Ω at 0°C, standard type class A or B to IEC 751
potting compound
3 or 4 wire connections
 $\geq 100 \text{ M}\Omega$, test voltage 250 V at ambient temperature

radius block for pipe diameters up to 4"
flat block for pipes from 5" and flat surface
Aluminium
50 x 30 x 15 mm

PVC insulated / PVC sheathed, 4 wires
PTFE insulated / Silicone rubber sheathed, 4 wires
PTFE insulated / PTFE sheathed, 4 wires
1000, 2000, 2500, 3500 mm; others on request
PVC / PVC : -20°C to +70°C
PTFE / Silicone : -20°C to +180°C
PTFE / PTFE : -20°C to +180°C
free end wires

Product structure

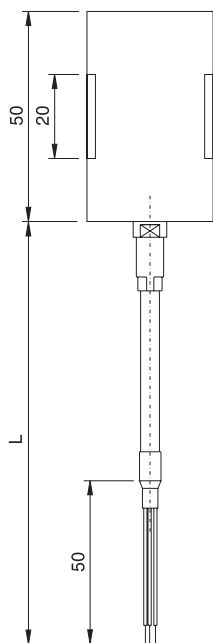
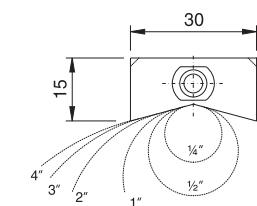

TST602

(all dimensions in millimeters)

TST602- RTD Thermometer

Surface thermometer suitable for application measurement on flat surfaces or pipes, with connection cable and radius or flat mounting block in aluminium

Mounting version, material

- A - 50 x 30 x 15 radius block mounting
- B - 50 x 30 x 15 flat block mounting

RTD class and type of construction

- B - 1 Pt100, class B, 3 wires
- H - 1 Pt100, class A, 3 wires
- M - 1 Pt100, class A, 4 wires
- Y - RTD class and type to specification

Connection cable length L (500-3000mm)

- 1 - 1000 mm
- 2 - 2000 mm
- 3 - 2500 mm
- 4 - 3500 mm
- 8 - mm length to specification
- 9 - mm special length

Connection cable type

- A - PVC insulated - PVC sheathed - 4 wires
- B - PTFE insulated - Silicone sheathed - 4 wires
- C - PTFE insulated - PTFE sheathed - 4 wires
- Y - Connection cable type to specification

Connection cable, terminal type

- 11 - Free end wires
- 99 - Connection to specification

Built-in transmitter

- 0 - Without built-in transmitter

TST602-

Complete Order Code

Accessories



TAF10

Field housing TAF10

For field mounting a TAF10 housing for transmitter installation is available.

For further information please refer to:

- ☐ Field housing TAF10
- Operating Instructions KA 093R/09/a2

Installation

Pipe mounting example using a hose clamp (not included):

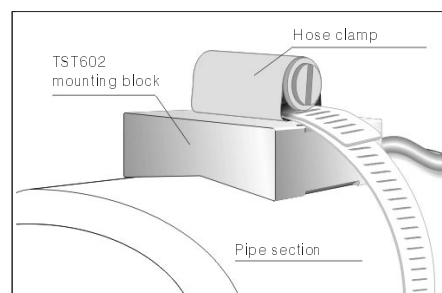

United Kingdom

UK Head Office and
Production Centre:

Floats Road
Manchester
M23 9NF
Tel. no. (0161) 2 86 50 00
Fax no. (0161) 9 98 18 41

Regional Offices:

London
Tel. no. (0181) 9 03 95 69
Fax no. (0181) 9 03 93 12

Glasgow
Tel. no. (0141) 2 48 62 34

Export Division

Endress+Hauser
GmbH+Co.
Instruments International
P.O. Box 2222
D-79574 Weil am Rhein
Germany

Tel. (07621) 975-02
Fax (07621) 975-345
<http://www.endress.com>
info@ii.endress.com

