

Assembly for Conductivity Measurement *DipFit W CLA 111*

Immersion and process assembly for open and closed tanks with DN 100 flange



DipFit W CLA 111 with adjustable flange

DipFit W CLA 111 with DN 100 flange

Areas of application

The immersion and process assembly DipFit W CLA 111 is intended for universal

use in the water / waste water treatment areas and in process applications.

The Chemoclean system for chemical cleaning of measuring cells can be integrated without the need to convert the assembly.

The following accessories are available:

- Spray head
- Mounting frame
- Pendulum frame
- Retrofit kit for mounting on pendulum frame.

Benefits at a glance

- Made of environmentally compatible polypropylene material
- Flexible immersion depth thanks to adjustable flange; additional bayonet locking mechanism assures easy installation and removal of assembly
- Simple installation and removal of measuring cell holder due to bayonet lock mounting method
- One measuring cell mounting position suitable for measuring cells CLS 21 and CLS 40 with integrated Pt 100
- Reduced condensation of water due to naturally breathing Goretex® filter
- All accessories can be retrofitted without the need to convert the assembly.

Quality made by
Endress+Hauser



ISO 9001

Endress + Hauser

Nothing beats know-how



Types and mounting versions

DipFit W CLA 111

Mounting versions

A, B and D

- 1 Assembly head with integrated cable connection terminals
- 2 Pg 13.5
- 3 Star handle screws
- 4 DN 100 flange
- 5 Measuring cell holder
- 6 Adapter for adjustable flange
- 7 Suspension bracket
- 8 Weight (half shells)

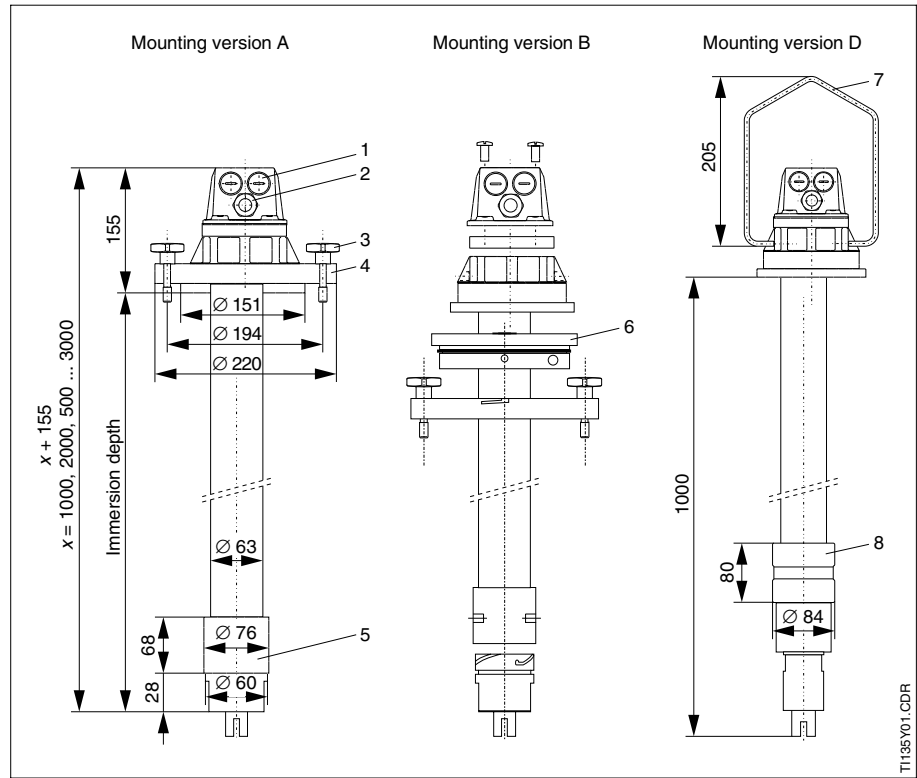

left:

DN 100 flange for mounting versions A and B

- 1 Through hole for captive star handle screws with loss protection

right:

Measuring cells CLS 21, CLS 40 and spray head CLR 30 (for CLS 21) in the measuring cell holder. The values are excess lengths when screwed in.

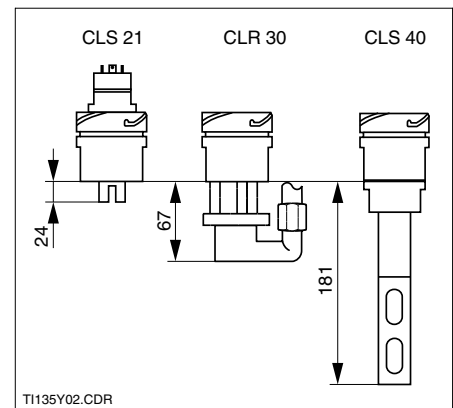
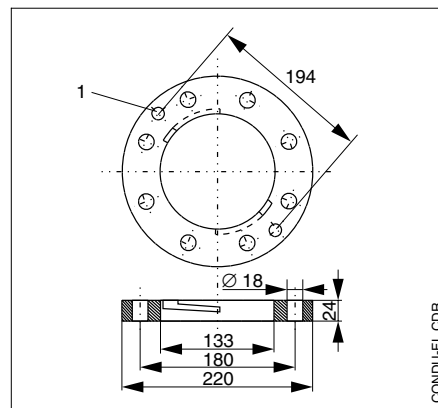

The assembly can be mounted using a standard DN 100 flange (mounting version A). Additional captive star handle screws allow to attach the assembly to a mounting frame for convenient installation on basin or channel walls.

The adjustable flange (mounting version B) can be used to adapt the immersion depth to local conditions. The adapter for the adjustable flange is firmly attached in the desired position on the immersion tube. The bayonet lock integrated on the flange allows easy installation and removal of the assembly without need to dismantle the flange.

The suspended version of the DipFit W CLA 111 (mounting version D) can be installed in immersion tanks using assembly holder CYH 101. With a suspension chain, the immersion depth can be varied.

Electrical connection

Fig. ①:
Measuring cable connection
1 Assembly head cover
2 Terminals
3 Assembly head
4 Measuring cable socket
5 Conductivity measuring cell
6 Measuring cell holder
7 Pg cable gland

Fig. ②:
Electrical connection of CLS 21

Fig. ③:
Electrical connection of CLS 40

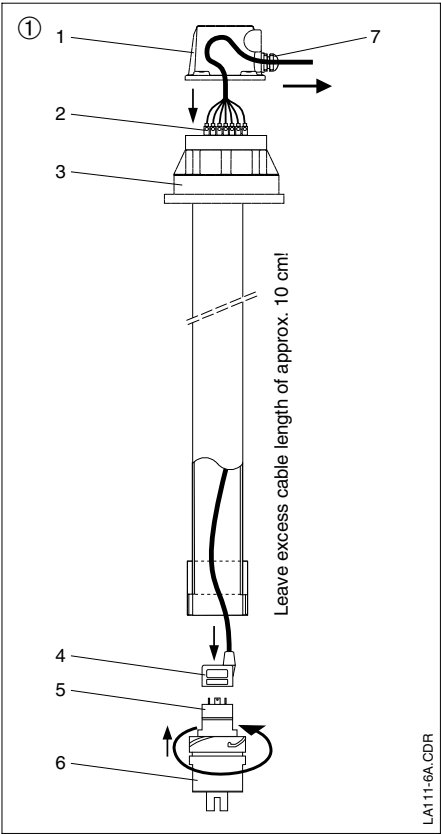

The right-angle connector of the CLS 21 is replaced by the supplied measuring cell cable. The cable end is connected to the terminals in the assembly head.

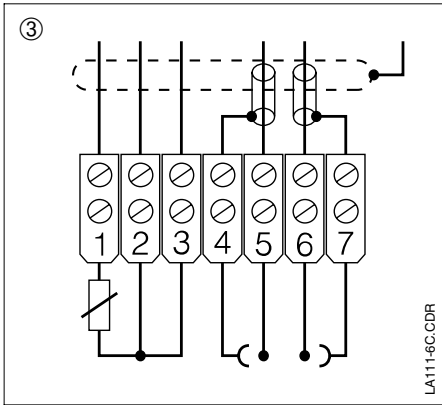
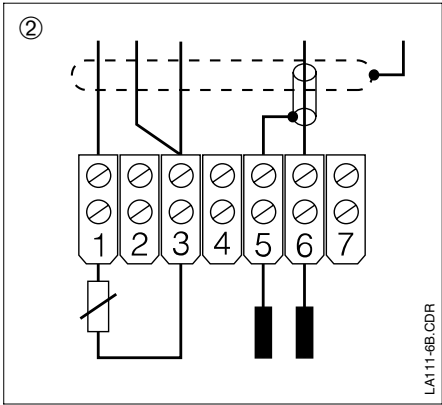

The measuring cable of the CLS 40 is connected directly to the terminals in the assembly head.

Accessories

left:
Spray head CLR 30 for Chemoclean cleaning system; can be retrofitted, no need to convert the assembly; material: PP

right:
Pendulum frame for pendulous suspension of the assembly; material: stainless steel 1.4301



- ❑ Spray head CLR 30 for CLS 21 (see operating instructions CLA 111, no. 50073950)
- ❑ Mounting frame (order no. 50066561)
- ❑ Pendulum frame (order no. 50080196)
- ❑ Retrofit kit for mounting on pendulum frame (order no. 50087873)

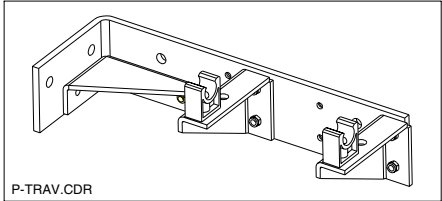

Mounting frame for installation on basin or channel walls; for mounting versions A and B; material: stainless steel 1.4301

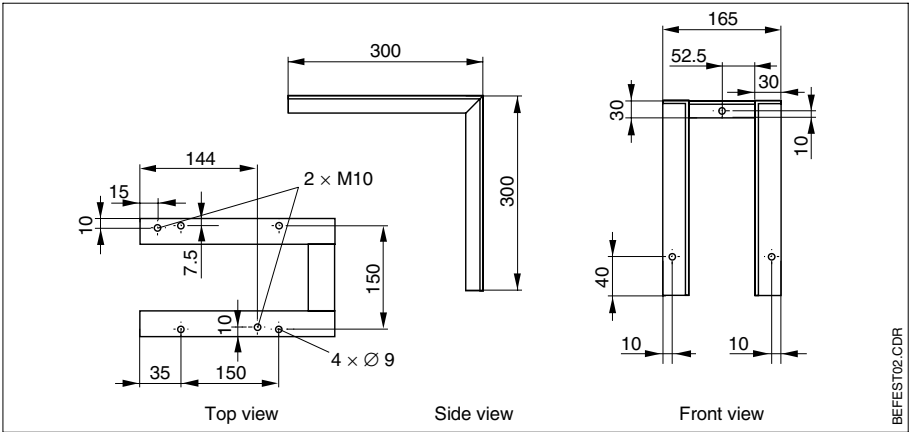

Technical data

General data

| | |
|---------------------|-------------------------|
| Manufacturer | Endress+Hauser GmbH+Co. |
| Product designation | DipFit W CLA 111 |

Mounting

| | |
|-----------|---|
| Version A | DN 100 flange, with additional captive star handle screws |
| Version B | DN 100 adjustable flange |
| Version D | suspension bracket; material: stainless steel 1.4571 |

Suitable measuring cells

| | |
|--------|---|
| CLS 21 | see Technical Information CLS 21, no. 50059352 |
| CLS 40 | see Technical Information CLS 40, no. 50059354 |
| CLS 15 | see Technical Information CLS 15, no. 50065950; special measuring cell holder required |

Materials in contact with medium

| | |
|-----------------------|----------|
| Measuring cell holder | PP-GF 20 |
| Immersion tube | PP |
| O-ring | EPDM |

Operating pressure and temperature

| | |
|---------------------------------|----------------------|
| All mounting versions (A, B, D) | unpressurised, 80 °C |
|---------------------------------|----------------------|

Dimensions and weight

| | |
|---------------------------------|--|
| Cable gland | 2 × Pg 16, 1 × Pg 13.5 |
| Immersion depth | standard: 1000, 2000 mm; special depths: 500 ... 3000 mm |
| Required mounting cross section | DN 100 |
| Weight | approx. 4 kg |

How to order

Immersion assembly DipFit W CLA 111

Length of assembly

0 1000 mm

1 2000 mm

2 special length (500 ... 3000 mm; only A)

9 special version

Material

0 PP

9 special version

Mounting versions

A DN 100 flange of PP, unpressurised

B DN 100 adjustable flange of PP (variable adjustment of immersion depth)

D suspension bracket of stainless steel 1.4571

Y special version

CLA 111-

complete order code

Endress+Hauser GmbH+Co.
- Instruments International -
P.O. Box 2222
D-79574 Weil am Rhein
Tel. (07621) 975 - 02
Fax (07621) 975345