

Field Data Processor *Promonitor NRF560*

For tank side monitoring and control the
Proservo intelligent tank gauge



Application

Promonitor is a Field data processing unit for use with the Proservo series of tank gauges. Mounted at the tank side or remotely (up to 1200 metres away) the Promonitor provides indication of all available tank data and control of the Proservo tank gauge from a convenient location.

Features

- Remote monitoring and control of Proservo
- Indication via two line illuminated display
- Operation of Proservo via 3 optical keys and E+H user friendly programming matrix.
- Multi-language text. (English, German, Japanese etc.).
- IP 67 corrosion resistant weather-proof housing.
- Explosion proof for the hazardous area mounting.

Endress + Hauser

Nothing beats know-how



System Configuration

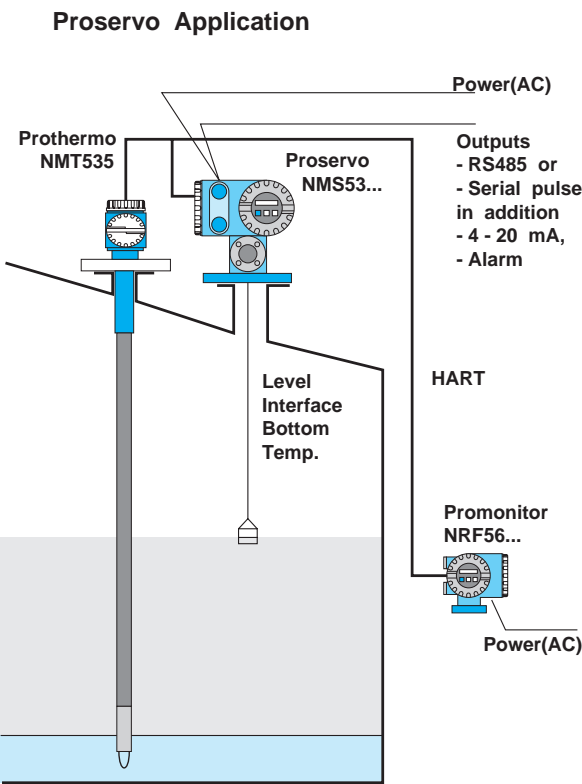

Promonitor is a tank side monitoring and control station for the Proservo series of intelligent tank gauges. The NRF560 is a simple low cost tank side monitor for displaying level interface level, tank bottom and temperature. Additionally the Proservo can be operated to measure the level, interface, tank bottom or to hoist the displacer. Operation of the tank gauge is via 3 optical operating keys (touch control). Transmission between Proservo and NRF560 is via two wire Hart Protocol.

Display / Operation

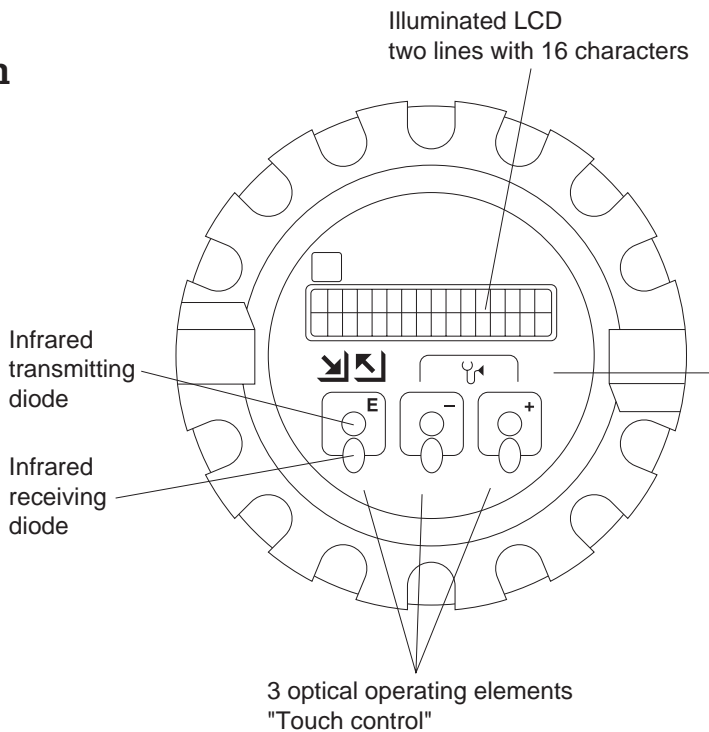

The Promonitor NRF560 has a two line illuminated Liquid crystal display and touch control to help choose data indication operation of the Proservo. The LCD and touch control is mounted within a flameproof (weatherproof) enclosure to ensure safe operation in hazardous areas. The NRF560 has a two display modes level / temperature indication and gauge operation. The Proservo operations available from the NRF560 are:

- Level measurement
- Displacer hoist
- Interface level measurement
- Tank bottom measurement

Electrical Connections

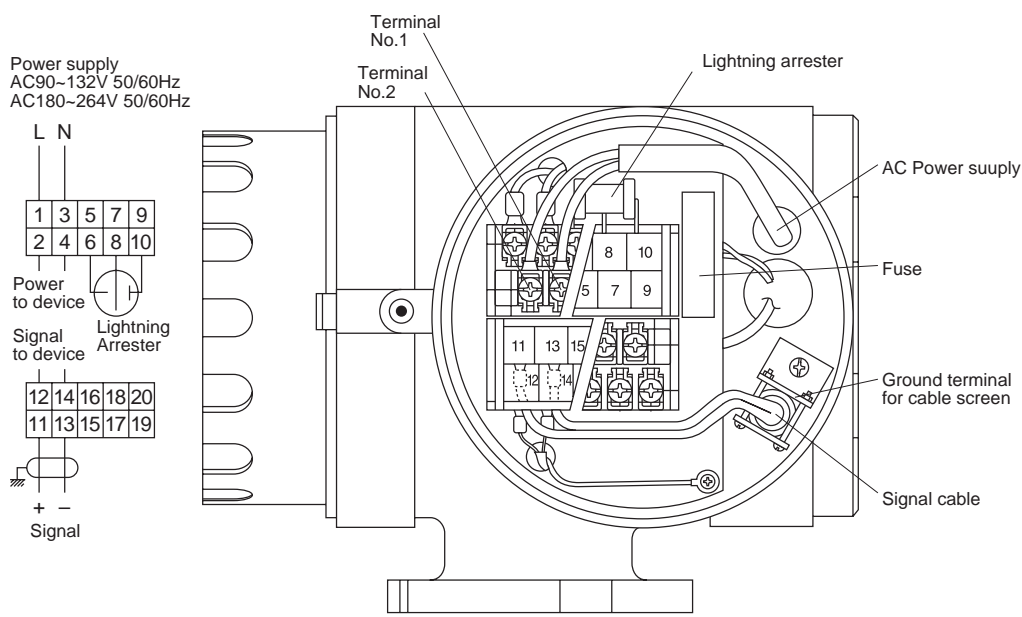

Dimensions

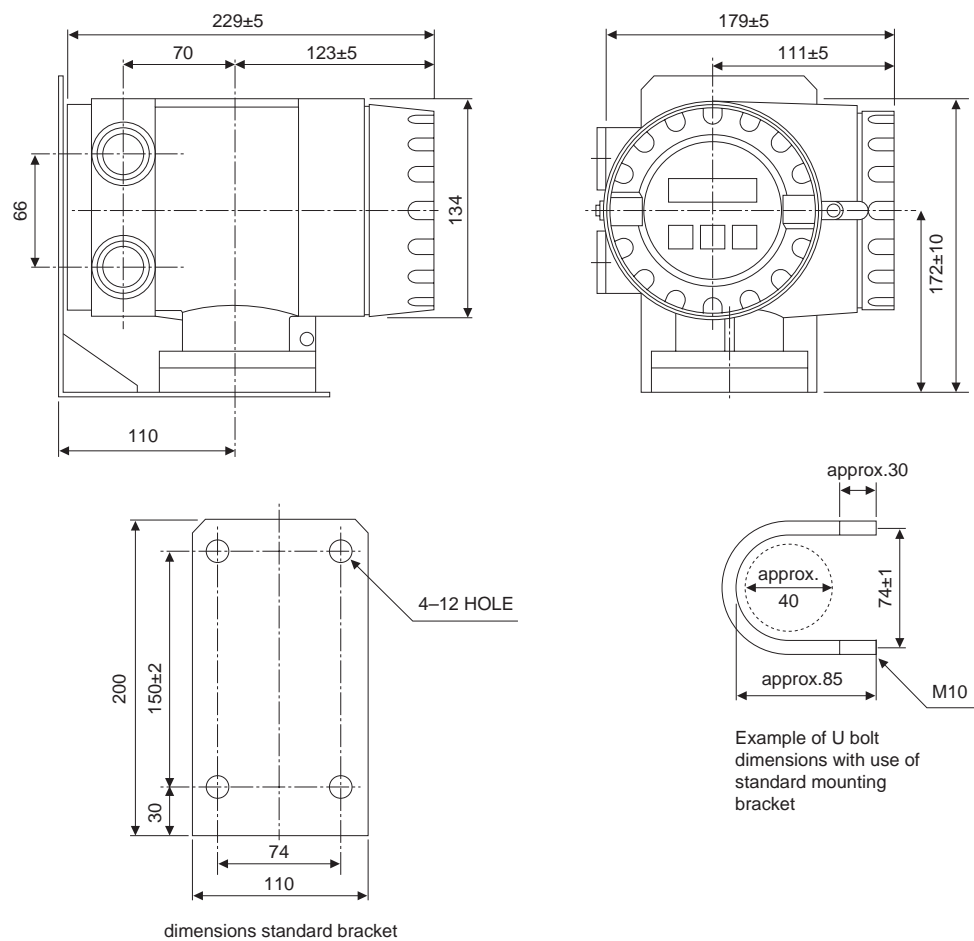

Technical Data

General Specification	Manufacturer Designation Function	Sakura Endress Co Ltd Promonitor NRF 560 Tankside Monitor / controller
Input Characteristics	Signal	Multi drop Hart protocol max.15 devices DC 24V
Display / Programming	Display (LCD)	Two lines 16 digits illuminated display language selectable English, German, Japanese etc.
	Programming	3 Optical keys for selection of matrix functions (Touch control)
Power Supply	Power Supply	AC90 - 132 volts 50/60 Hz or AC180 - 260 volts 50/60 Hz(switchable) AC50 - 60 volts 50/60Hz
	Power consumption	approx. 10VA
Certification	Explosion proof	Exd II BT4 BVS Cenelec, (RIIS)
Environmental Conditions	Ambient Temp. Protection	-20.....+60 deg. C IP67 with closed housing and cable glands of same protection type.
	Housing -material of construction Weight	Aluminium coated with anti - acid paint. Approx. 6.5kg
	Electro magnetic compatibility	Immunity and emission to EN 50082 -1,2

Product Structure

Promonitor NRF560

Protection

- 0 Weatherproof
- 1 Flameproof (RIIS, Exd II B T4)
- 2 Flameproof (BVS,Exd II B T6)
- 9 others

Cable Entry

- A 2 x G(PF) 1/2" Thread
- B 2 x NPT 1/2" Thread
- C 2 x PG16 Thread
- D 2 x M22 Thread
- Y Others

Power Supply

- 0 AC 90 - 132V
- 1 AC 180 - 260V
- 9 others

Mounting Bracket

- 0 None
- 1 With standard bracket
- 9 Others

Painting

- 0 Standard
- 9 Others

NRF560

Ordering code

UK

Whessoe Varec Ltd.
Heighington Lane
Newton Aycliffe
County Durham
England
DL5 6AX
Tel. +44 (0)1325 301 100
Fax +44 (0)1325 300 840

Japan

Sakura Endress Co.,
Ltd.
3-4-22 Naka-Machi
Musashino-Shi
Tokyo 180
Tel. (04 22) 54 06 11
Fax (04 22) 55 02 75
Telex 028-22615



Endress + Hauser
Nothing beats know-how

